

# Sikla Framo Modular Steelwork

Dalkia selected a flexible structural framework system for a new air compressor house project to support mechanical and electrical services. This system was assessed against traditional hot rolled galvanised steelwork, and the Sikla Frame system was selected over conventional solutions.

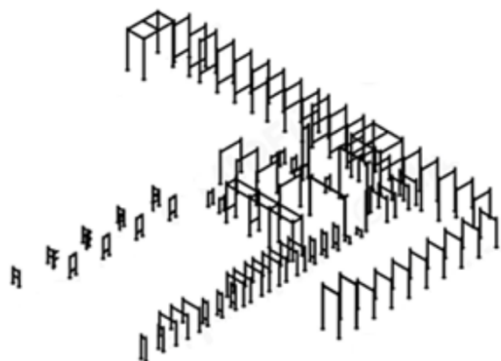

The design checks included static imposed loads, overturning and wind loading with the final solution modelled in Revit complete with Bill of Material quantities. Foundation pads were designed to coordinate with the Framo span lengths and standard holding down plates.

The sections were cut to length then packed with labelling to identify their frame type. Assembly and installation of the Framo was considerably shorter than hot rolled steelwork and required no telehandler or crane lifts due to its lightweight construction.

Sikla Framo support steelwork framing offers several advantages over comparable hot rolled steels:-

## Key Points

1. Multi-functional and self-explanatory support system.
2. Minimum installation time.
3. Safe handling on the construction site.
4. Regulatory Compliance.
5. Continuous connection.
6. Torsion-resistant sections.
7. One single type of screw for all components.
8. Design changes can be adapted immediately and without loss of time on the construction site.
9. Reusable after disassembly, all components have the high-quality HCP coating with 15-year warranty.



**For More Information Contact Nick Hyde, Dalkia Engineering, 07703 495812,**