

Building the London Eye

Building the London Eye was a real challenge and the result was a impressive structure which had great solutions to both engineering and safety problems.

The Risks

Falls from height, drowning and working next to the Thames.

The Solution

Early identification of the issues to the client and contractor to encourage off-site working where possible. Analysis of the river access and craneage capabilities of the site were essential to validate the decisions and locations of large modules.

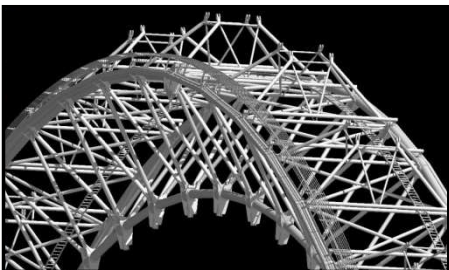
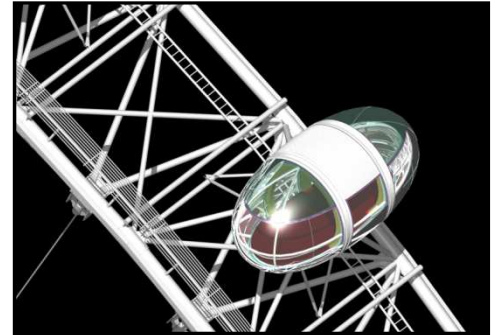

Key Points

1. Prefabrication reduces work at height.
2. Off-site fabrication in factory conditions offers more control and quality.
3. Heavy module lifting can be hazardous but requires less lifts.
4. Offsite fabrication can cause access and transportation issues.
5. Review the build-ability and access issues with contractor as early as possible.
6. Cost benefits may be possible as well as safety benefits.
7. Fall arrest with boat recovery strategy was used.
8. Prefabrication can be advantageous to CDM but is not always the answer.

